

**LGS 240 G**

|                   | Part No.     |
|-------------------|--------------|
| LGS 240 G - 3.0 m | K10429-24-3M |
| LGS 240 G - 4.0 m | K10429-24-4M |
| LGS 240 G - 5.0 m | K10429-24-5M |

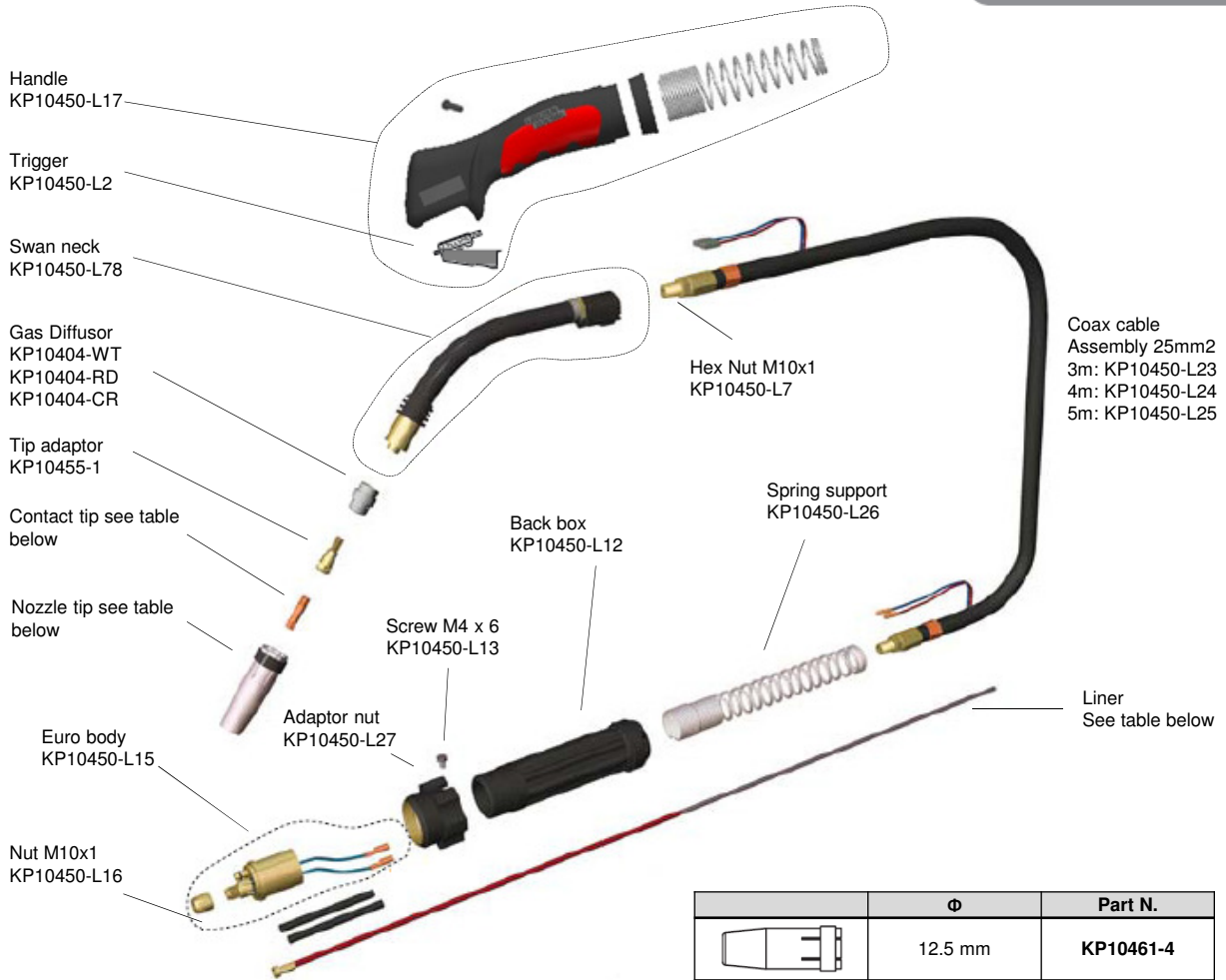

|                 | M6x25       |             |                   |             |
|-----------------|-------------|-------------|-------------------|-------------|
|                 | 0.8 mm      | 0.9 mm      | 1.0 mm            | 1.2 mm      |
| <b>ECu</b>      | KP10440-08  | KP10440-09  | <b>KP10440-10</b> | KP10440-12  |
| <b>CuCrZr</b>   | KP10440-08C | KP10440-09C | KP10440-10C       | KP10440-12C |
| <b>Al (Ecu)</b> | KP10440-08A | KP10440-09A | KP10440-10A       | KP10440-12A |

|  | Φ       | Part N.          |
|--|---------|------------------|
|  | 12.5 mm | <b>KP10461-4</b> |
|  | 10 mm   | KP10461-9        |
|  | 17 mm   | KP10460-4        |
|  | 17 mm   | KP10463-4        |

|                                    |      | Ø                          | x                 |                   |                   |
|------------------------------------|------|----------------------------|-------------------|-------------------|-------------------|
|                                    |      |                            | 3 m               | 4 m               | 5 m               |
| <b>Steel liner</b>                 | blue | <b>Steel</b>               | KP10413-3M        | KP10413-4M        | KP10413-5M        |
|                                    | red  |                            | <b>KP10414-3M</b> | <b>KP10414-4M</b> | <b>KP10414-5M</b> |
| <b>PTFE liner</b>                  | blue | Alu,<br>Stainless,<br>CuSi | KP10422-3M        | KP10422-4M        | KP10422-5M        |
|                                    | red  |                            | KP10418-3M        | KP10418-4M        | KP10418-5M        |
| <b>Aluminum kit (PTFE /bronze)</b> | red  | Alu,<br>Stainless,<br>CuSi | KP10419-3M        | KP10419-4M        | KP10419-5M        |

# Maintenance and User Manual



**Warning: Risk of electric shock!**

**Always disconnect the welding machine from the line power before maintenance, inspection, or exchange of spare parts.**

## Precautions

|  |  |
|--|--|
|  |  |
|  |  |
|  |  |
|  |  |
|  |  |