

LG 250 G-E

	Part No.
LG 250 G-E - 3.0 m	K10413-25E-3M
LG 250 G-E - 4.0 m	K10413-25E-4M
LG 250 G-E - 5.0 m	K10413-25E-5M

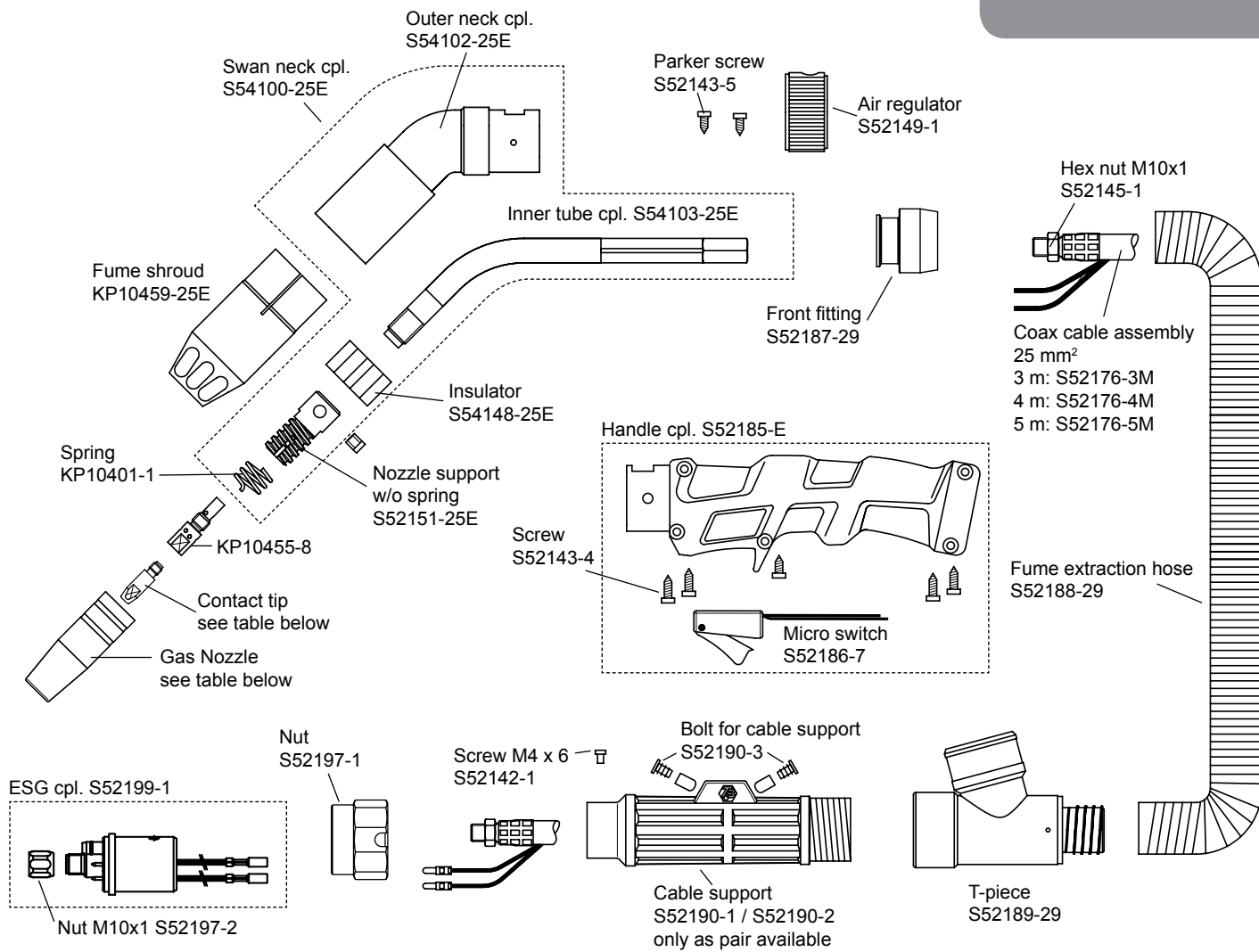

	M6 x 28 mm		
	0.8 mm	1.0 mm	1.2 mm
ECu	KP10441-08	KP10441-10	KP10441-12
CuCrZr	KP10441-08C	KP10441-10C	KP10441-12C
Al (ECu)	KP10441-08A	KP10441-10A	KP10441-12A

	Ø	Part No.
	15 mm	KP10461-2
	20 mm	KP10460-2

		Ø	X			
			3 m	4 m	5 m	
Steel liner	blue	Steel	0.8 - 1.0	KP10413-3M	KP10413-4M	KP10413-5M
	red		1.0 - 1.2	KP10414-3M	KP10414-4M	KP10414-5M
PTFE liner	blue	Alu, Stainless, CuSi	1.0 - 1.2	KP10422-3M	KP10422-4M	KP10422-5M
	red		1.0 - 1.2	KP10418-3M	KP10418-4M	KP10418-5M
Aluminum kit (PTFE /bronze)	red	Alu, Stainless, CuSi	1.0 - 1.2	KP10419-3M	KP10419-4M	KP10419-5M



Maintenance and Users Manual



Warning: Risk of electric shock!

Always disconnect the welding machine from the line power before maintenance, inspection, or exchange of spare parts.

Precautions

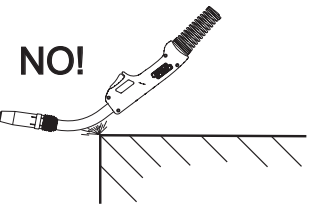

NO!  **OK** 