

# LTP SERIES HAND HELD TIG (GTAW) TORCHES CE

---

Range overview.....	1
Expendables for use with standard collet body.....	2
Expendables for use with gas lens .....	2
Spare Parts.....	4



GRAPHICS MAY VARY

ENGLISH



LINCOLN ELECTRIC EUROPE S.L  
c/o Balmes, 89 - 8<sup>o</sup> 2<sup>a</sup>, 08008 Barcelona, Spain  
[www.lincolnelectric.eu](http://www.lincolnelectric.eu)

# Range overview

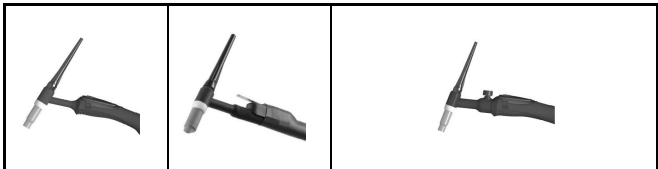

COOLING	SIZE	Cable length	Ergo	French lever	Valve Conn. 10-25	Valve Conn. 35-50
Air	17	4	K10529-17-4		K10529-17-4VS	K10529-17-4V
		8	K10529-17-8	K10529-17-8F	--	K10529-17-8V
	26	4	K10529-26-4		--	K10529-26-4V
		8	K10529-26-8	K10529-26-8F	--	K10529-26-8V
		12	K10529-26-12			
	26 Flex Neck	4	K10529-26-4X	--	--	--
		8	K10529-26-8X	--	--	--
	Water	20	4	K10529-20-4		--
8			K10529-20-8	K10529-20-8F	--	--
18		4	K10529-18-4		--	--
		8	K10529-18-8	K10529-18-8F	--	--
18 Flex Neck		4	K10529-18-4X	--	--	--
		8	K10529-18-8X	--	--	--
18SC		4	--	--	--	--
		8	K10529-18SC-8	--	--	--

## Expendables for use with standard collet body

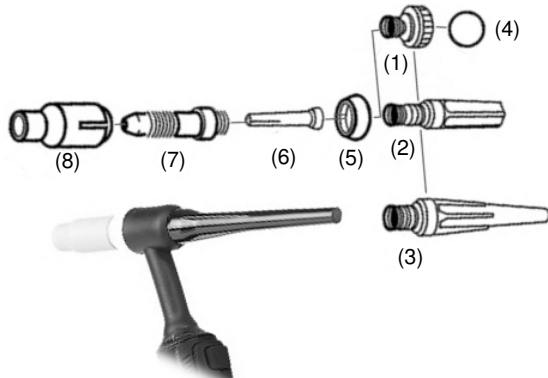

		17/18/26		18 SC		20	
	Description	Part Number	Int. Ref.	Part Number	Int. Ref.	Part Number	Int. Ref.
1	Cap - Short	KP10509-1	57Y04	KP10509-1	57Y04	KP10508-1	41V33
2	Cap - Medium	KP10509-2	57Y05	KP10509-2	57Y05	KP10508-2	41V35
3	Cap - Long	<b>KP10509-3</b>	<b>57Y02</b>	<b>KP10509-3</b>	<b>57Y02</b>	<b>KP10508-3</b>	<b>41V24</b>
4	O-ring	KP10509-4	300M02	KP10509-4	300M02	KP10508-4	VS-1-02
5	Insulator	KP10511-1	18CG	KP10511-18	18NG	KP10510-1	598882
6	Collet 1,0 mm	KP10503-10	10N22	KP10503-10	10N22	KP10502-10	13N21
	Collet 1,6 mm	KP10503-16	10N23	KP10503-16	10N23	KP10502-16	13N22
	Collet 2,4 mm	<b>KP10503-24</b>	<b>10N24</b>	<b>KP10503-24</b>	<b>10N24</b>	<b>KP10502-24</b>	<b>13N23</b>
	Collet 3,2 mm	KP10503-32	10N25	KP10503-32	10N25	KP10502-32	13N24
	Collet 4,0 mm	-----	-----	KP10503-20HD	54N20HD	-----	-----
7	Collet Body 1,0 mm	KP10505-10	10N30	KP10504-53	NCB-53	KP10504-10	13N26
	Collet Body 1,6 mm	KP10505-16	10N31	KP10504-53	NCB-53	KP10504-16	13N27
	Collet Body 2,4 mm	<b>KP10505-24</b>	<b>10N32</b>	<b>KP10504-53</b>	<b>NCB-53</b>	<b>KP10504-24</b>	<b>13N28</b>
	Collet Body 3,2 mm	KP10505-32	10N28	KP10504-53	NCB-53	KP10504-32	13N29
	Collet Body 4,0 mm	-----	-----	KP10504-36	NCB-36	-----	-----
8	Ceramic Nozzle 6,5 mm	KP10514-4	10N50	KP10515-4	54N18	KP10512-4	13N08
	Ceramic Nozzle 8,0 mm	KP10514-5	10N49	KP10515-5	54N17	KP10512-5	13N09
	Ceramic Nozzle 9,5 mm	<b>KP10514-6</b>	<b>10N48</b>	<b>KP10515-6</b>	<b>54N16</b>	<b>KP10512-6</b>	<b>13N10</b>
	Ceramic Nozzle 11,0 mm	KP10514-7	10N47	KP10515-7	54N15	KP10512-7	13N11
	Ceramic Nozzle 12,5 mm	KP10514-8	10N46	KP10515-8	54N14	KP10512-8	13N12
	Ceramic Nozzle 16,0 mm	KP10514-10	10N45	KP10515-12	54N19	KP10512-10	13N13
	Ceramic Nozzle 19,0 mm	KP10514-12	10N44	-----	-----	-----	-----

Part numbers in bold are standard.

# Expendables for use with gas lens

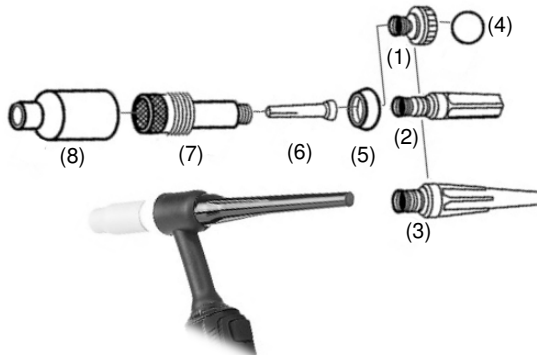

		17/18/26		18 SC		20	
	Description	Part Number	Int. Ref.	Part Number	Int. Ref.	Part Number	Int. Ref.
1	Cap - Short	KP10509-1	57Y04	KP10509-1	57Y04	KP10508-1	41V33
2	Cap - Medium	KP10509-2	57Y05	KP10509-2	57Y05	KP10508-2	41V35
3	Cap - Long	KP10509-3	57Y02	KP10509-3	57Y02	KP10508-3	41V24
4	O-ring	KP10509-4	300M02	KP10509-4	300M02	KP10508-4	VS-1-02
5	Insulator	KP10511-2	54N01	KP10511-18	18NG	KP10510-1	598882
6	Collet 1,0 mm	KP10503-10	10N22	KP10503-10	10N22	KP10502-10	13N21
	Collet 1,6 mm	KP10503-16	10N23	KP10503-16	10N23	KP10502-16	13N22
	Collet 2,4 mm	KP10503-24	10N24	KP10503-24	10N24	KP10502-24	13N23
	Collet 3,2 mm	KP10503-32	10N25	KP10503-32	10N25	KP10502-32	13N24
	Collet 4,0 mm	KP10503-40	54N20	KP10503-20HD	54N20HD	-----	-----
7	Gas Lens 1,0 mm	KP10507-10	45V24	KP10507-804	18GL04	KP10506-10	45V42
	Gas Lens 1,6 mm	KP10507-16	45V25	KP10507-816	18GL16	KP10506-16	45V43
	Gas Lens 2,4 mm	KP10507-24	45V26	KP10507-832	18GL32	KP10506-24	45V44
	Gas Lens 3,2 mm	KP10507-32	45V27	KP10507-818	18GL18	KP10506-32	45V45
	Gas Lens 4,0 mm	KP10507-40	45V28	KP10507-853	18GL53	-----	-----
8	Ceramic Nozzle 6,5 mm	KP10515-4	54N18	KP10515-4	54N18	KP10513-4	53N58
	Ceramic Nozzle 8,0 mm	KP10515-5	54N17	KP10515-5	54N17	KP10513-5	53N59
	Ceramic Nozzle 9,5 mm	KP10515-6	54N16	KP10515-6	54N16	KP10513-6	53N60
	Ceramic Nozzle 11,0 mm	KP10515-7	54N15	KP10515-7	54N15	KP10513-7	53N61
	Ceramic Nozzle 12,5 mm	KP10515-8	54N14	KP10515-8	54N14	KP10513-8	53N61S
	Ceramic Nozzle 17,5 mm	KP10515-12	54N19	KP10515-12	54N19	-----	-----

# Spare Parts

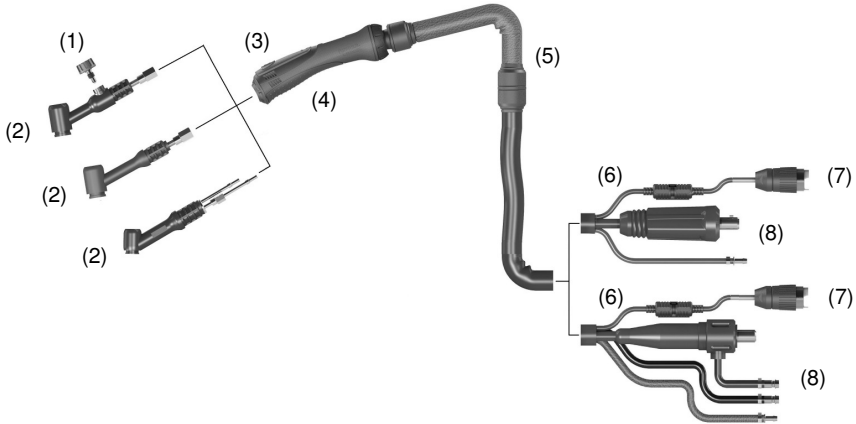

## Torch bodies & valves (Drawings 1 - 2)

Part Number	Description	Part Number	Description
S52901-1	VS917 Valve for LTP17	S52902-5	Torch body standard for LTP18SC
S52901-2	VS26 Valve for LTP26	S52902-6	Torch body standard for LTP20
S52902-1	Torch body standard for LTP17	S52902-7	Torch body standard for LTP26
S52902-2	Torch body valve for LTP17	S52902-8	Torch body flexible for LTP26
S52902-3	Torch body standard for LTP18	S52902-9	Torch body valve for LTP26
S52902-4	Torch body flexible for LTP18		

## Switch modules & handles (Drawings 3 - 4)

Part Number	Description	Part Number	Description
KP10529-2	Module 1-button for LTP	S52903-1	Handle complete with 1-button switch Lincoln for LTP17/20
KP10529-1	Module 1-button + 10KΩ Poti Module + 6 pins plug for LTP	S52903-2	Handle complete with 1-button switch Lincoln for LTP18/18SC/26
KP10529-3	Module 3-buttons for LTP		

## Sheathing sets (Drawing 5)

Part Number	Description	Part Number	Description
S52906-1	Complete sheathing set for type 17/20 4mtr	S52907-1	Complete neoprene sheathing set for type 17V 4mtr
S52906-2	Complete sheathing set for type 17/20 8mtr	S52907-2	Complete neoprene sheathing set for type 17V 8mtr
S52906-3	Complete sheathing set for type 18/18SC/26 4mtr	S52907-3	Complete neoprene sheathing set for type 26V 4mtr
S52906-4	Complete sheathing set for type 18/18SC/26 8mtr	S52907-4	Complete neoprene sheathing set for type 26V 8mtr

## Trigger cables & plugs (Drawings 6 - 7)

Part Number	Description	Part Number	Description
S52905-1	Trigger cable set Lincoln 5PT 4mtr (includes 5 pins plug)	KP10529-5	5 pins plug (with quick connect system) for LTP
S52905-2	Trigger cable set Lincoln 5PT 8mtr (includes 5 pins plug)	KP10529-4	6 pins plug (with quick connect system) for LTP
S52905-3	Trigger cable set Lincoln 6PA 4mtr (includes 6 pins plug)		
S52905-4	Trigger cable set Lincoln 6PA 8mtr (includes 6 pins plug)		

## Power/gas & Power/gas/water complete cable sets (Drawing 8)

Part Number	Description	Part Number	Description
S52904-1	Power/gas cable set for LTP17 4mtr with 10-25mm2 plug	S52904-6	Power/gas/water cable set for LTP18/18SC 4mtr with 35-50mm2 plug
S52904-2	Power/gas cable set for LTP17 4mtr with 35-50mm2 plug	S52904-7	Power/gas/water cable set for LTP18/18SC 8mtr with 35-50mm2 plug
S52904-3	Power/gas cable set for LTP17 8mtr with 35-50mm2 plug	S52904-8	Power/gas/water cable set for LTP20 4mtr with 35-50mm2 plug
S52904-4	Power/gas cable set for LTP26 4mtr with 35-50mm2 plug	S52904-9	Power/gas/water cable set for LTP20 8mtr with 35-50mm2 plug
S52904-5	Power/gas cable set for LTP26 8mtr with 35-50mm2 plug		